

Voluntary Facility #1

Emer. Exit

Main Entry / Exit

Outdoor Refrigeration

“Conserved” Facility Space Requirements

16 clients per facility (64 clients total)

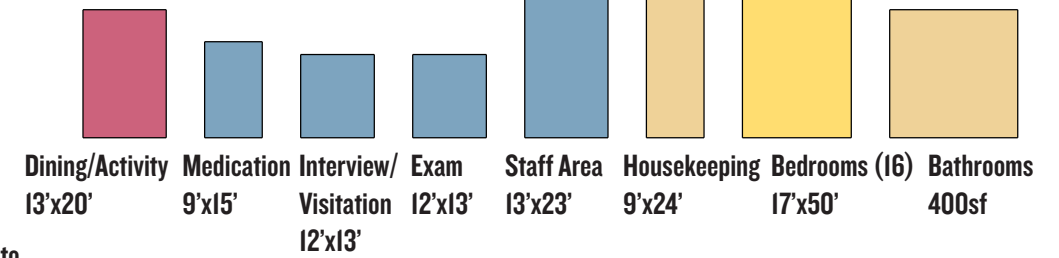

“Voluntary” Facility Space Requirements

28 to 30 clients per facility (57 clients total)

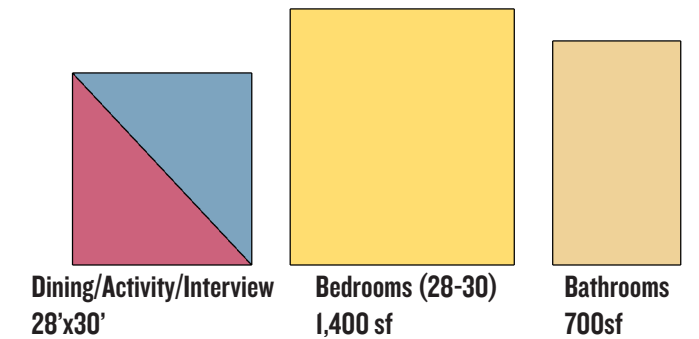

- Client Common Area (Dining, Activity, Social)
- Office/Medical
- Conserved Bedrooms (100sf - 10'x10')
- Voluntary Bedrooms (50sf - 5'x10')
- Client Circulation
- Staff Circulation / Monitored Client Circulation
- Service / Restrooms / Storage
- Existing Conference, Cafe, Kitchen, Multipurpose
- Existing Spaces Not Accessible to Clients

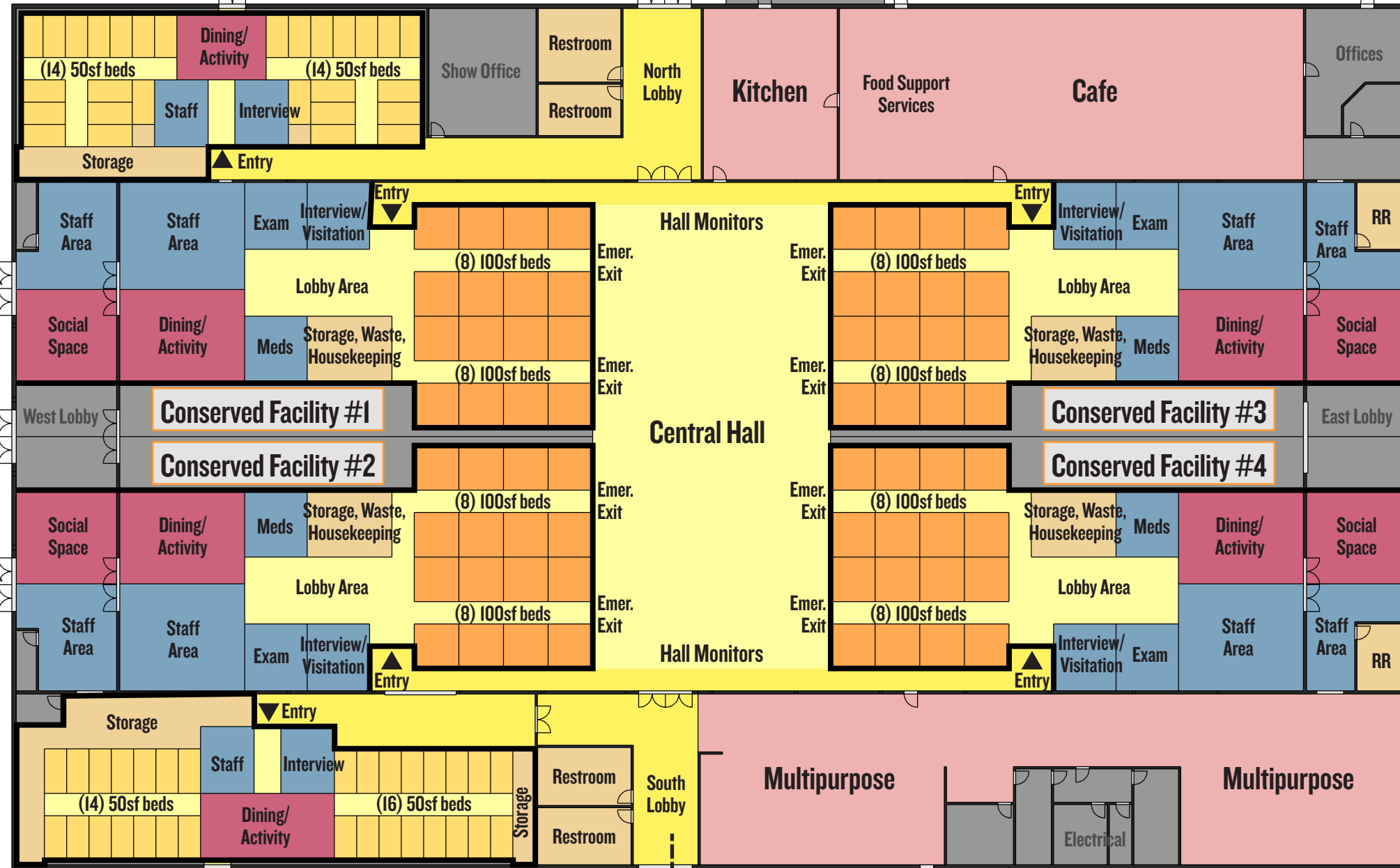

Voluntary Facility #2

Emer. Exit

Exit to Restroom Trailers

Restroom and Shower Trailers



SMCEC EMERGENCY FACILITY LAYOUT | FIESTA HALL - POST CONSTRUCTION

SAN MATEO, CA | JUNE 2, 2020 | SAN MATEO COUNTY EVENT CENTER

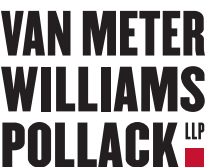

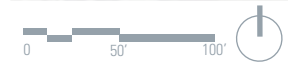
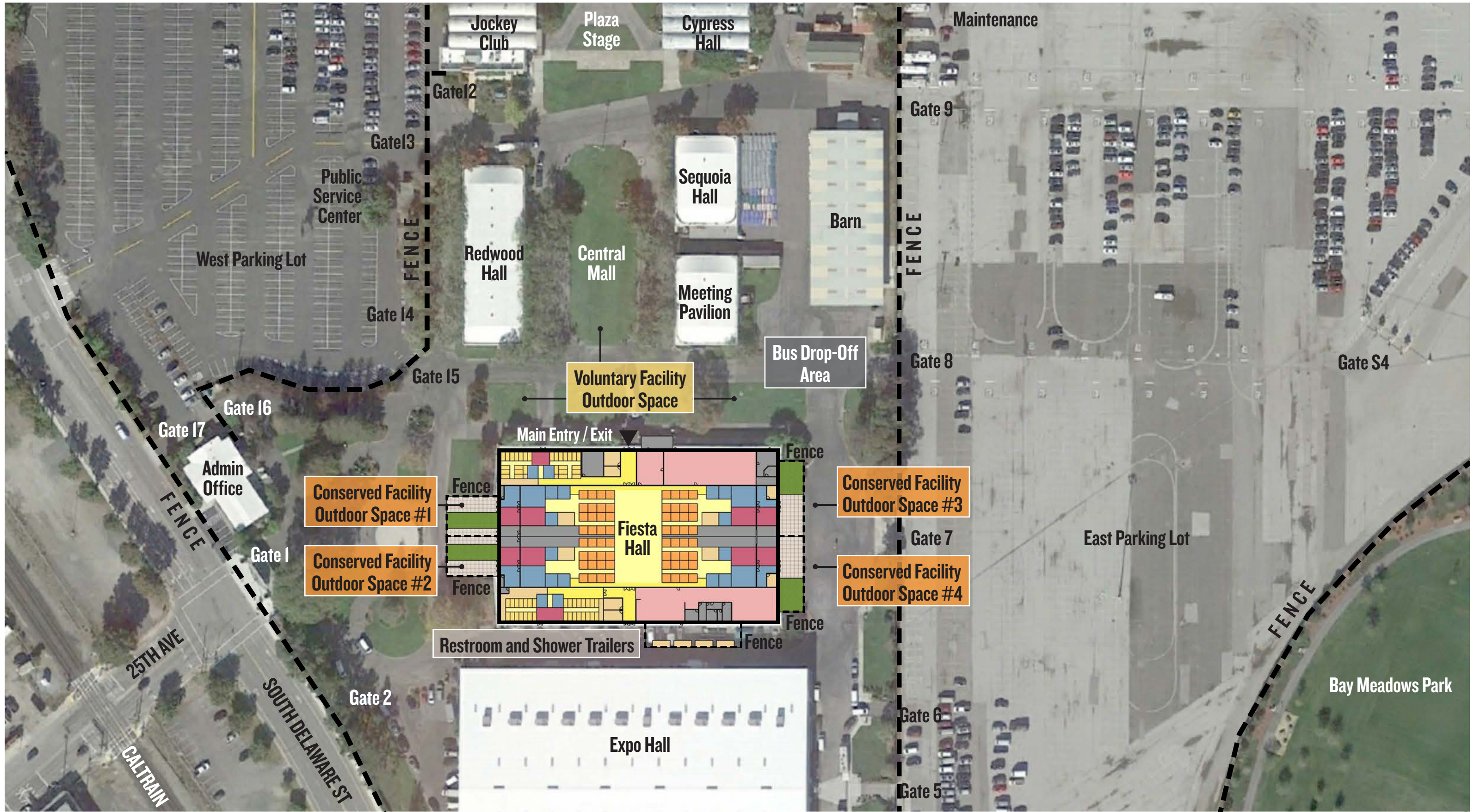

SMCEC EMERGENCY FACILITY LAYOUT | FIESTA HALL - POST CONSTRUCTION - SITE CONTEXT

SAN MATEO, CA | JUNE 2, 2020 | SAN MATEO COUNTY EVENT CENTER

